

TUBE ELBOWS

TUBE ELBOWS WITH TANGENT ENDS

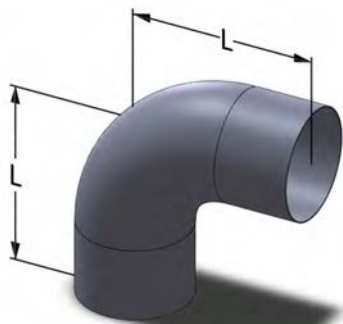

PE - PLAIN TUBE ENDS

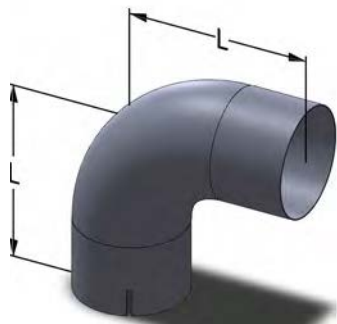

PS - PLAIN TUBE ENDS X SLOTTED CUFF

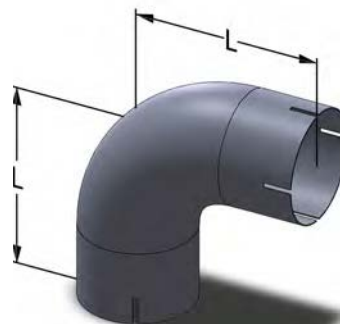

S/R ELBOW				PLAIN ENDS		PLAIN X SLOTTED		SLOTTED ENDS	
TUBE O.D.	RAD.	L	THK.	CARBON STEEL	T-304 S/S	CARBON STEEL	T-304 S/S	CARBON STEEL	T-304 S/S
2"	2.00	6.00	0.065	PE0200	PE0200H	PS0200	PS0200H	SC0200	SC0200H
2-1/2"	2.50	6.50	0.065	PE0250	PE0250H	PS0250	PS0250H	SC0250	SC0250H
3"	3.00	7.00	0.065	PE0300	PE0300H	PS0300	PS0300H	SC0300	SC0300H
3-1/2"	3.50	7.50	0.065	PE0350	PE0350H	PS0350	PS0350H	SC0350	SC0350H
4"	4.00	8.00	0.065	PE0400	PE0400H	PS0400	PS0400H	SC0400	SC0400H
5"	5.00	9.50	0.065	PE0500	PE0500H	PS0500	PS0500H	SC0500	SC0500H
6"	6.00	10.00	0.065	PE0600	PE0600H	PS0600	PS0600H	SC0600	SC0600H
8"	8.00	13.88	0.109	PE0800	PE0800H	PS0800	PS0800H	SC0800	SC0800H
10"	10.00	14.00	0.135	PE1000	PE1000H	PS1000	PS1000H	SC1000	SC1000H
12"	12.00	16.00	0.109	PE1200	PE1200H	PS1200	PS1200H	SC1200	SC1200H
14"	14.00	18.00	0.109	N/A	PE1400H	N/A	N/A	N/A	N/A
16"	16.00	20.00	0.135	N/A	PE1600H	N/A	N/A	N/A	N/A
18"	18.00	22.00	0.135	N/A	PE1800H	N/A	N/A	N/A	N/A

L/R ELBOW				PLAIN ENDS		PLAIN X SLOTTED		SLOTTED ENDS	
TUBE O.D.	RAD.	L	THK.	CARBON STEEL	T-304 S/S	CARBON STEEL	T-304 S/S	CARBON STEEL	T-304 S/S
2"	4.00	8.00	0.065	PEL0200	PEL0200H	PSL0200	PSL0200H	SCL0200	SCL0200H
2-1/2"	5.00	9.00	0.065	PEL0250	PEL0250H	PSL0250	PSL0250H	SCL0250	SCL0250H
3"	6.00	10.00	0.065	PEL0300	PEL0300H	PSL0300	PSL0300H	SCL0300	SCL0300H
3-1/2"	7.00	11.00	0.065	PEL0350	PEL0350H	PSL0350	PSL0350H	SCL0350	SCL0350H
4"	8.00	12.00	0.065	PEL0400	PEL0400H	PSL0400	PSL0400H	SCL0400	SCL0400H
5"	10.00	14.00	0.065	PEL0500	PEL0500H	PSL0500	PSL0500H	SCL0500	SCL0500H
6"	12.00	16.00	0.065	PEL0600	PEL0600H	PSL0600	PSL0600H	SCL0600	SCL0600H
8"	12.00	16.00	0.109	N/A	PEL0800H	N/A	PSL0800H	N/A	SCL0800H
10"	15.00	19.00	0.135	N/A	PEL1000H	N/A	PSL1000H	N/A	SCL1000H
12"	18.00	22.00	0.109	N/A	PEL1200H	N/A	PSL1200H	N/A	SCL1200H
14"	21.00	25.00	0.109	N/A	PEL1400H	N/A	N/A	N/A	N/A
16"	24.00	28.00	0.135	N/A	PEL1600H	N/A	N/A	N/A	N/A
18"	27.00	31.00	0.135	N/A	PEL1800H	N/A	N/A	N/A	N/A

NOTES

- Slotted Cuffs are Tube Size.

OPTIONS

- Transition Cuffs for Size Reduction.
- Longer / Shorter Lengths Available.
- Pipe Size Cuffs are Available.
- Flanged Ends Available.
- T-316 Stainless Steel Available on Request.



Contact One Of Our Product Specialists For Assistance

