

CLAMPS

ECT



TST



HCT

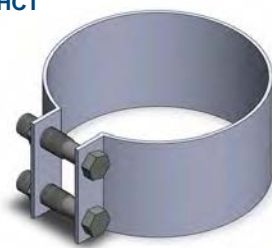

SIZE	FITS O.D.	U-BOLT SADDLE CLAMP ZINC PLATED PART NO.	3" WIDE S/S BAND CLAMP STRETCH OVER JOINT FOR SEALING ONLY PART NO.	2-1/2" WIDE 12GA T-304 S/S HEAVY DUTY CLAMP CUSTOM SIZES AVAIL. PART NO.
1.50" TUBE	1.50	ECT-0150	TST-0150	N/A
1.50" PIPE	1.90	ECP-0150	N/A	N/A
2" TUBE	2.00	ECT-0200	TST-0200	N/A
2" P PE	2.38	ECP-0200	N/A	N/A
2-1/2" TUBE	2.50	ECT-0250	TST-0250	N/A
2-1/2" PIPE	2.88	ECP-0250	N/A	N/A
3" TUBE	3.00	ECT-0300	TST-0300	N/A
3" P PE	3.50	ECP-0300	TSP-0300	HCP-0300
3-1/2" TUBE	3.50	ECT-0350	TST-0350	HCT-0350
3-1/2" PIPE	4.00	ECP-0350	TSP-0350	HCP-0350
4" TUBE	4.00	ECT-0400	TST-0400	HCT-0400
4" P PE	4.50	ECP-0400	N/A	HCP-0400
5" TUBE	5.00	ECT-0500	TST-0500	HCT-0500
5" P PE	5.56	ECP-0500	N/A	HCP-0500
6" TUBE	6.00	ECT-0600	TST-0600	HCT-0600
6" P PE	6.63	ECP-0600	N/A	HCP-0600
8" TUBE	8.00	N/A	TST-0800	HCT-0800
8" P PE	8.63	N/A	N/A	HCP-0800
10" TUBE	10.00	N/A	TST-1000	HCT-1000
10" PIPE	10.75	N/A	N/A	HCP-1000
12" TUBE	12.00	N/A	TST-1200	HCT-1200
12" PIPE	12.75	N/A	N/A	HCP-1200
14" PIPE	14.00	N/A	N/A	HCP-1400
16" PIPE	16.00	N/A	N/A	HCP-1600
18" PIPE	18.00	N/A	N/A	HCP-1800
20" PIPE	20.00	N/A	N/A	HCP-2000
22" PIPE	22.00	N/A	N/A	HCP-2200
24" PIPE	24.00	N/A	N/A	HCP-2400



V-BAND CLAMPS

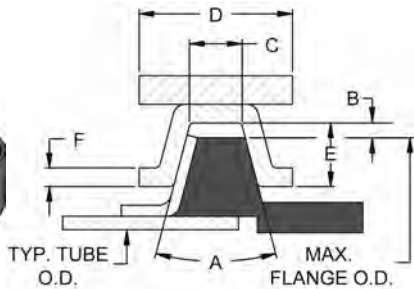
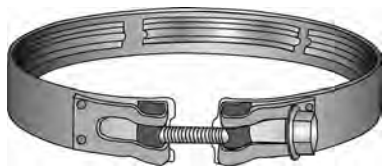

SIZE	A	B	C	D	E	F	MAX FLG.	PART NO.	COMPATIBLE WITH
3-1/2"	40°	4.50	0.207	0.88	0.28	0 080	4.38	V88-356	JOHN DEERE
4"	40°	4.81	0.207	0.88	0.28	0 080	4.63	V88-469	JOHN DEERE
5"	40°	5.43	0.262	0.75	0.14	0 050	5.15	V88-456	DETROIT
5"	40°	5.88	0.400	0.88	0.28	0 050	5.73	V88-506	CUMMINS
5"	40°	5.86	0.293	1.13	0.30	0 050	5.80	V88-511	DETROIT

Contact One Of Our Product Specialists For Assistance

