

# EZH CATALYTIC HOUSING SERIES

## EZH SERIES OVERVIEW

With more than 100 years experience in silencing design and manufacturing, Maxim has developed the Maxim EZH Catalytic Housing Series. Maxim EZH catalytic housings are engineered for small horsepower engines. The EZH housing maximizes catalyst life with EZ to change out replacement elements. Designed and constructed of stainless steel to provide years of service. The EZH provides multiple preflow and postflow sample ports and can accommodate one or two elements in a single unit. Our catalytic housings operate with non-dithering or dithering AFR control schemes. Maxim Silencers are proudly made in the USA.

## FEATURES

- EZ access to catalysts, one person can service unit
- Element capacity: one or two, in a single unit
- Heavy duty, welded stainless steel construction
- ANSI drilled flanges on inlet and outlet
- Preflow and postflow sampling ports
- Made in the USA

## ENGINE APPLICATIONS

- CAT G3300 Series
- CAT G3400 Series
- Cummins
- Arrow
- Waukesha

## OPTIONS / ACCESSORIES

- Sizes available 12 in. or 14.5 in.
- Complete range of exhaust accessories

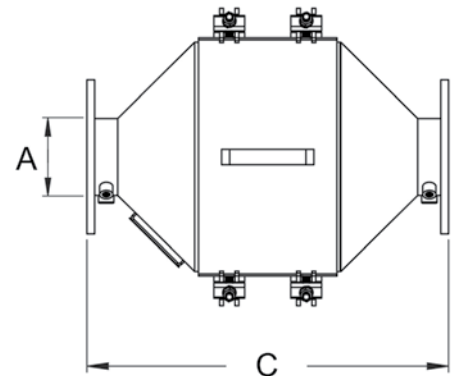
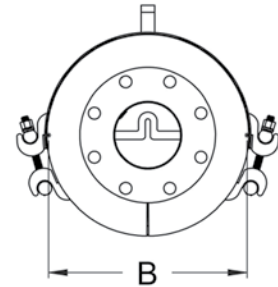

| <b>EZH</b>         |             |          |          |          |               |
|--------------------|-------------|----------|----------|----------|---------------|
| <b>Part Number</b> | <b>Size</b> | <b>A</b> | <b>B</b> | <b>C</b> | <b>Est Wt</b> |
| PTEZH-1200         | 12          | 5        | 12       | 23.5     | 52            |
| PTEZH-1450         | 14.5        | 5        | 14.5     | 23.5     | 56            |

Dimensions are in inches. Weights are in pounds.